

Renovations to the Clark Haddad Memorial Building / Sand Hill School Building - General Bid

<u>Category:</u>	Clubs, Community Centers	<u>Project ID #:</u>	1004554012
<u>Street Address:</u>	16 Dewey Ave. Sandwich MA 02563	<u>Confirmed Value</u>	\$800,000.00
<u>County:</u>	Barnstable	<u>Stage:</u>	BIDDING - Biddate Set
<u>Bid Date:</u>	12/13/2017 , 02:00PM		
<u>Architect:</u>	McGinley Kalsow & Associates		
<u>Documents Available:</u>	Plans, Specs available in Insight		Plans available from Town of Sandwich
<u>Last Update:</u>	11/13/2017		MacLeod Consulting, Inc. was added as Structural Engineer

Project Events

Event	Date	Details
Bid Date	12/13/2017 , 02:00PM	Town of Sandwich, 130 Main Street Sandwich, MA 02563
End Date	7/11/2018	
Pre-Bid Meeting	11/14/2017 , 02:00PM	Pre-bid Conference at Clark Haddad Memorial Building/Sand Hill School, 16 Dewey Avenue, Sandwich.
Start Date	1/12/2018	Actual Start Date

Notes

<u>Scope</u>	Renovation of a clubhouse / community center in Sandwich, Massachusetts. Completed plans call for the renovation of a clubhouse / community center. Renovations to the Clark Haddad Memorial Building / Sand Hill School Building for use as a Town of Sandwich Community Center Contractor QualificationDCAMM Certificate Work will be Substantially Completed within 180 calendar days.
<u>Notes</u>	Bid Date: 12/13/2017 02:00PM Town of Sandwich, 130 Main Street Sandwich, MA 02563 Pre-Bid Meeting: 11/14/2017 02:00PM Pre-bid Conference at Clark Haddad Memorial Building/Sand Hill School, 16 Dewey Avenue, Sandwich. Development include(s): Renovation
<u>Details</u>	[Division 2]: Building Demolition, Clearing, Dewatering, Shoring, Earthwork, Grading, Slope Protection & Erosion Control, Paving & Surfacing, Water Systems, Sewerage & Drainage, Landscaping. [Division 3]: Concrete Formwork, Concrete Reinforcement, Structural Concrete, Structural Precast Concrete. [Division 4]: Clay Unit Masonry. [Division 5]: Cold Formed Metal Framing, Metal Fabrications. [Division 6]: Rough Carpentry, Finish Carpentry, Architectural Woodwork, Stairwork & Handrails. [Division 7]: Firestopping. [Division 8]: Wood Doors, Hardware. [Division 9]: Ceiling Suspension Systems, Drywall/Gypsum, Tile, Wood Flooring, Resilient Flooring, Painting. [Division 10]: Wall & Corner Guards, Toilet & Bath Accessories. [Division 14]: Material Handling Systems. [Division 15]: Plumbing Fixtures, Heat Pumps, Packaged A/C Units, Ductwork, Testing & Balancing. [Division 16]: Service/Distribution, Interior Lighting, Exterior Lighting, Alarm & Detection Systems.

Additional Details

<u>Listed On:</u>	11/9/2017	<u>Floor Area:</u>	
<u>Contract Type:</u>		<u>Work Type:</u>	Alteration
<u>Stage Comments 1:</u>		<u>Floors Below Grade:</u>	
<u>Stage Comments 2:</u>		<u>Owner Type:</u>	City
<u>Bid Date:</u>	12/13/2017	<u>Mandatory Pre Bid Conference:</u>	
<u>Invitation #:</u>	1731.00	<u>Commence Date:</u>	1/12/2018
<u>Structures:</u>	1	<u>Completion Date:</u>	7/11/2018
<u>Single Trade Project:</u>		<u>Site Area:</u>	
<u>Floors:</u>		<u>LEED Certification Intent:</u>	
<u>Parent Project ID:</u>		<u>Units:</u>	
<u>Parking Spaces:</u>			

Project Participants

Company Role	Company Name	Contact Name	Address	Phone	Email	Fax
Architect	McGinley Kalsow & Associates		324 Broadway P.O. Box 45248, Somerville, MA 02145	(617) 625-8901	info@mcginleykalso.com	(617) 625-8902
Structural Engineer	MacLeod Consulting, Inc.	Arthur H MacLeod	29 Woods Road , Belmont, MA 02478	(617) 484-4733	amacleod@macleod-consulting.com	(617) 484-9708

Owner	Town of Sandwich	George H Dunham	130 Main St , Sandwich, MA 02563	(508) 888-5144	townhall@townofsandwich.net	(508) 888-2497
Mechanical and Electrical Engineer	South Shore Engineering Team	James Stroke	720 Washington St. Suite 303, Hanover, MA 02339	(781) 331-4660		(781) 829-4405

Bidders

Company Name	Contact Name	Added Date	Address	Phone	Email	Bidding Role	Bid Rank	Bid Value	Fax Number
Brite-Lite Electrical Co	Cary Chu	11/13/2017	11 Front Street , Weymouth, MA 02188	(781) 340-9102	cchu@brite-lite-electrical.com	Prospective Bidder - General Contractor			(781) 340-1674
Builder Systems Inc.	Christopher Raye	11/13/2017	135 Southbridge St P.O. Box 635, Auburn, MA 01501	(508) 798-8797	generalcontractors@buildersystemsinc.com	Prospective Bidder - General Contractor			(508) 752-9017
Annese Electrical Services	Mike Blotner	11/13/2017	280 Libbey Industrial Pkwy. , Weymouth, MA 02189	(781) 337-6462	mblotner@anneseelectric.com	Prospective Bidder - General Contractor			(781) 337-6559
Collins Construction Co.	Rebecca Collins	11/13/2017	33 Swindells St , Fall River, MA 02723	(508) 678-5201	becca@collinsconst.net	Prospective Bidder - General Contractor			(508) 672-2960
Reliable Roofing & Sheet Metal	James O'Donovan	11/13/2017	105 Irving St. , Framingham, MA 01702	(508) 628-5562	info@reliablene.com	Prospective Bidder - General Contractor			(508) 628-5563
Rockwell Roofing Inc.	Jennifer Wrightson	11/13/2017	44 Pond St , Leominster, MA 01453	(978) 537-7825	jennifer@rockwellroofing.com	Prospective Bidder - General Contractor			(978) 537-4132
Apex Corporation	Marc Sacco	11/13/2017	56 Charles St. , Abington, MA 02351	(781) 871-6227	apex@apexhvac.com	Prospective Bidder - General Contractor			(781) 871-5280
Capeway Roofing Systems	Kathie Rybicki	11/13/2017	664 Sandford Road , Westport, MA 02790	(508) 674-0800	krybicki@capewayroofing.com	Prospective Bidder - General Contractor			(508) 678-2670
Cam HVAC & Construction Inc.	Adam Petronio	11/13/2017	116 Lydia Ann Road , Smithfield, RI 02917	(401) 232-7230	Adam@CAMHVAC.com	Prospective Bidder - General Contractor			(401) 232-7290
Northern Contracting Corp.	Gaurang Parikh	11/13/2017	68 Jackson St. Canton, MA 02021	(781) 821-4200	gparikh@northerncontractingcorp.com	Prospective Bidder - General Contractor			(781) 821-4201
Robert B. Our Construction	Rich Zini	11/13/2017	24 Great Western Rd. PO Box 1539, Harwich, MA 02645	(508) 432-0530	RZini@robertb-our.com	Prospective Bidder - General Contractor			(508) 432-4385
Homer Contracting, Inc.		11/13/2017	195 Broadway , Arlington, MA 02474	(781) 648-3372	info@homercontracting.com	Prospective Bidder - General Contractor			(781) 648-4915
Greenwood Industries Inc.		11/13/2017	640 Lincoln St PO Box 2800,, Worcester, MA 01605	(508) 865-4040		Prospective Bidder - General Contractor			(508) 865-1123
General Mechanical Contractors	Michael Tomasino	11/13/2017	29A Sword St. Auburn, MA 01501	(508) 754-7366	support@generalinc.com	Prospective Bidder - General Contractor			(508) 756-6750
Campbell Construction Group	Annette Baldao	11/13/2017	21 Caller St Suite 4, Peabody, MA 01960	(978) 532-1998	annette@campbellgroupplc.com	Prospective Bidder - General Contractor			(978) 532-0998
Belcour Corporation	Donald Courmover	11/13/2017	99 Front St. , Woonsocket.	(401) 762-4685	belcour@verizon.net	Prospective Bidder -			(401) 762-4666

			RI 02895			General Contractor			
Vareika Construction Corp.	Kelly McGillis	11/13/2017	219 Walnut St. Suite B, West Bridgewater, MA 02379	(508) 583-3999	kelly@vareika.com	Prospective Bidder - General Contractor			(508) 583-6888
Araujo Bros Plumbing & Heating Inc.	Christopher Teixeira	11/13/2017	224 Nyes Lane , Acushnet, MA 02743	(508) 998-7006	info@araujobr plumbing.com	Prospective Bidder - General Contractor			(508) 998-1727
Seekonk heating services	William Murphy	11/13/2017	911 taunton ave , Seekonk, MA 02771	(508) 336-3069		Prospective Bidder - General Contractor			(508) 336-0883
M-V Electrical Contractors, Inc	Jonathan Rego	11/13/2017	10 Conduit St , Acushnet, MA 02743	(508) 995-3826		Prospective Bidder - General Contractor			(508) 995-0151
Silktown Roofing, Inc.	Eric Roth	11/13/2017	134 Ferry Street , South Grafton, MA 01560	(508) 887-8908	ericroth@silktownroofing.com	Prospective Bidder - General Contractor			(508) 887-8918
HTS Engineering Inc	Justin Thorpe	11/13/2017	One Corporation Wayt Suite 110, Peabody, MA 01960	(978) 977-9911	justin.thorpe@hts.com	Prospective Bidder - General Contractor			(978) 977-9941
Mello Electric Co	Steve Chouinard	11/13/2017	138 Morgan St , Fall River, MA 02721	(508) 679-3100	stevec@melloelectric.com	Prospective Bidder - General Contractor			(508) 679-1221
Delphi Construction	Robert Manganello	11/13/2017	130 Overland Road , Waltham, MA 02451	(781) 893-9900	info@delphiconstruction.com	Prospective Bidder - General Contractor			(781) 893-9898
DDC Construction Inc	David Dacosta	11/13/2017	20 Query Street , New Bedford, MA 02745	(508) 992-7112	mike@ddconstructioninc.com	Prospective Bidder - General Contractor			(508) 992-7429
Haynes Group	Anthony Lodi	11/13/2017	385 West Street , West Bridgewater, MA 02379	(508) 230-9494	info@haynesgroupinc.com	Prospective Bidder - General Contractor			(866) 209-5412
Dandis Contracting Inc	Patty Dandis	11/13/2017	1020 Turnpike Street, Unit 12, Canton, MA 02021	(781) 828-9313	pdandis@dancontracting.com	Prospective Bidder - General Contractor			(781) 828-9314
Drizos Contracting LLC	Spiros Drizos	11/13/2017	101 Middlesex Turnpike Ste 6 -353, Burlington, MA 01803	(978) 460-2241	spiros@drizoscontracting.com	Prospective Bidder - General Contractor			(781) 221-2245
American Electrical Construction, Inc.	Robert Sullivan	11/13/2017	180 South Meadow Road Unit C, Plymouth, MA 02360	(508) 747-5600	rsullivan@americanelectricaleconstruction.com	Prospective Bidder - General Contractor			(508) 747-5601
Encore Contracting Services Inc	Facundo Bergallo	11/13/2017	375 Common St., Lawrence, MA 01840	(978) 258-1744	fbergallo@encorecsi.com	Prospective Bidder - General Contractor			(978) 655-1758
K&K Acoustical Ceilings, Inc.	Kevin Kontos	11/13/2017	1881 Main St Ste. 7, Tewksbury, MA 01876	(978) 851-8844		Prospective Bidder - General Contractor			(978) 851-8291
BCM Controls	Peter Aisenberg	11/13/2017	30 Commerce Way , Woburn, MA 01801	(781) 933-8878	service@bcmcontrols.com	Prospective Bidder - General Contractor			(781) 932-3856
Veterans Development Corporation	Lynne Decker	11/13/2017	523 Great Road , Littleton, MA 01460	(781) 659-4050	ldecker@vetdevcorp.com	Prospective Bidder - General Contractor			(781) 659-0505
Kronenberger & Sons	Thomas Loveless	11/13/2017	355 Plymouth St. East	(508) 378-2007		Prospective Bidder -			

Restoration		Bridgewater, MA 02333		General Contractor			
-------------	--	--------------------------	--	-----------------------	--	--	--

Planholders

Company Name	Contact Name	Address	Phone	Email	Fax
Pmg Mechanical Systems	Paul Gens	11 Jan Sebastian Dr , Sandwich, MA 02563	(508) 888-1745	paul@pmgmechanical.com	
R.P. O'Connell Inc.	Robert O'Connell	3 Huron Drive , Natick, MA 01760	(508) 650-9400	rpoconnell@rpoconnell.com	(508) 650-9406

Contracts

Classification	Conditions	Bonding	Bid Date	Bids To	Bid Type
General Contractor		Bid:5.00%,Perf:100.00%,Pay:100.00%	12/13/2017	Owner	Open Bidding

History

User	Viewed	First Viewed Date	Currently Tracked?	Date Tracked
Adam Sweet	True	11/13/2017	False	

H:\Projects\2017\17005 McGinley Clark Haddad Memorial Building\Drawings\17005 WW.dwg

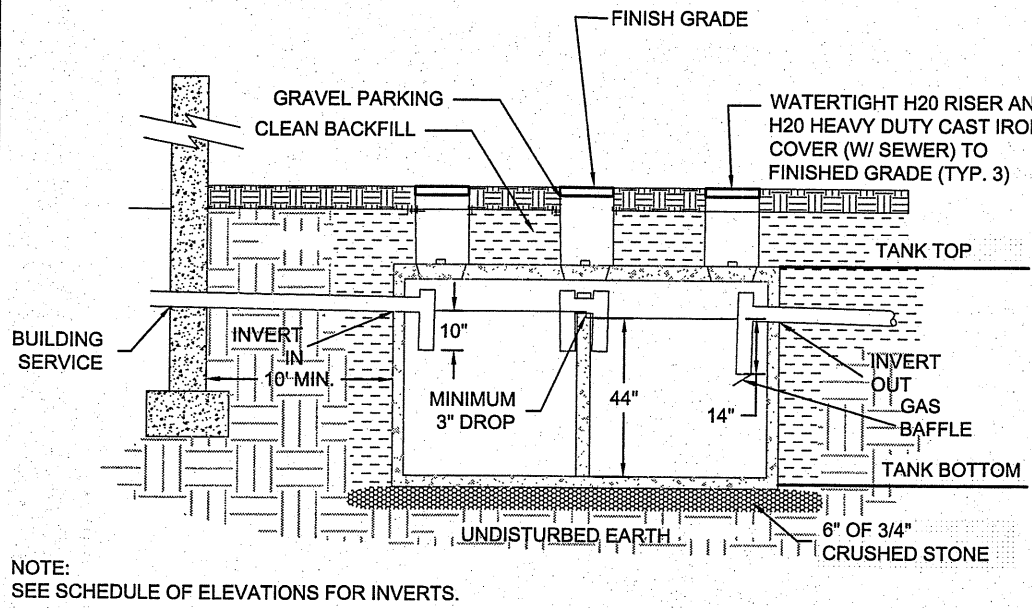

3,000 GALLON TWO COMPARTMENT SEPTIC TANK PROFILE
NOT TO SCALE

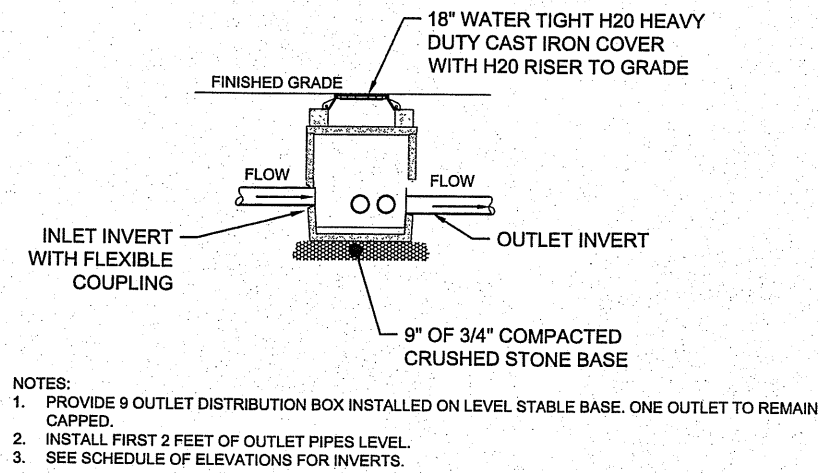

PROPOSED 9 OUTLET DISTRIBUTION BOX DETAIL
NOT TO SCALE

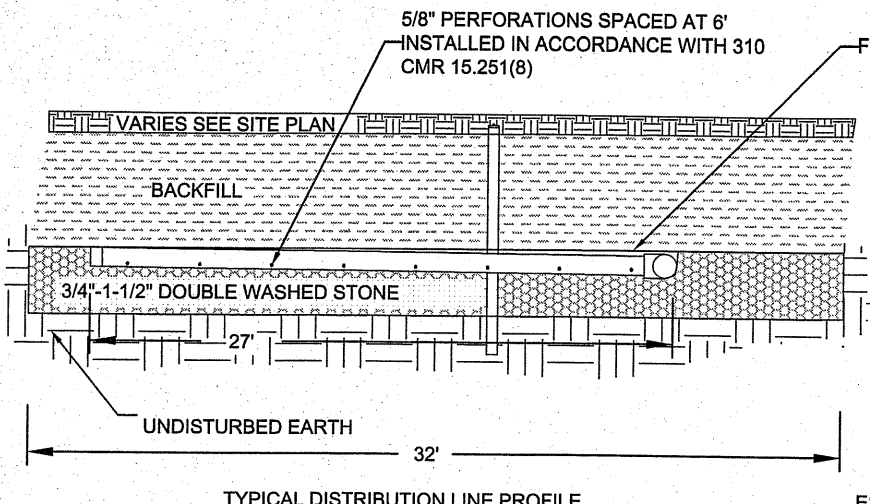

LEACHING FIELD DETAILS
NOT TO SCALE

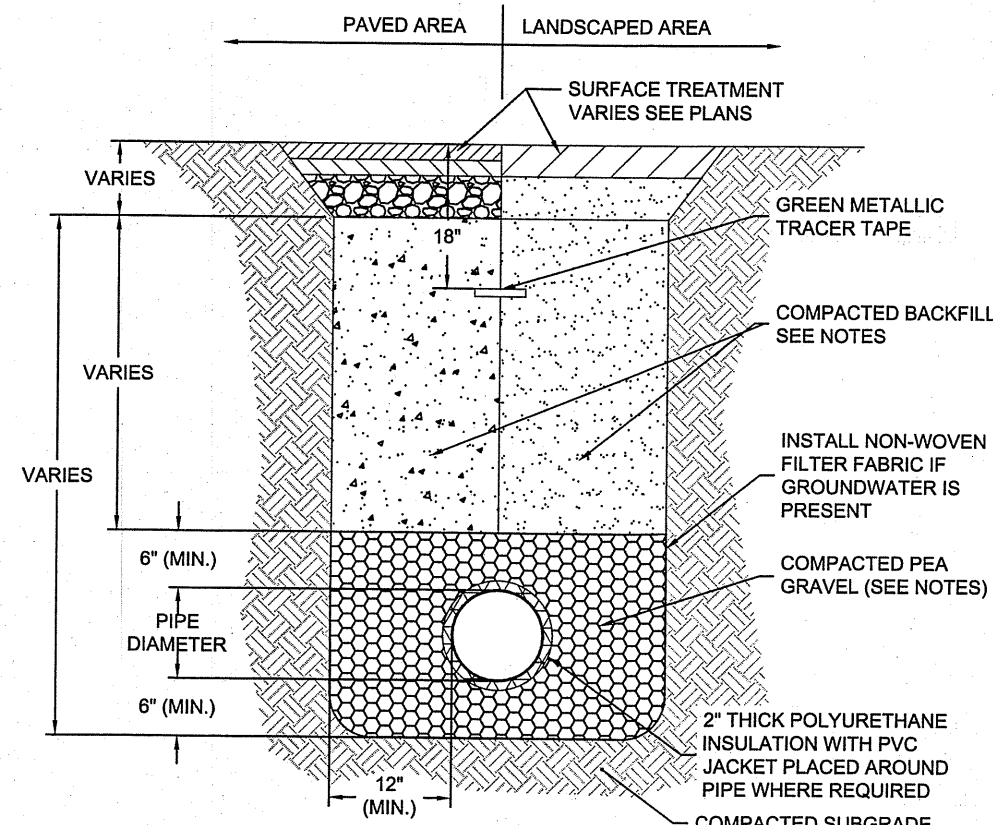
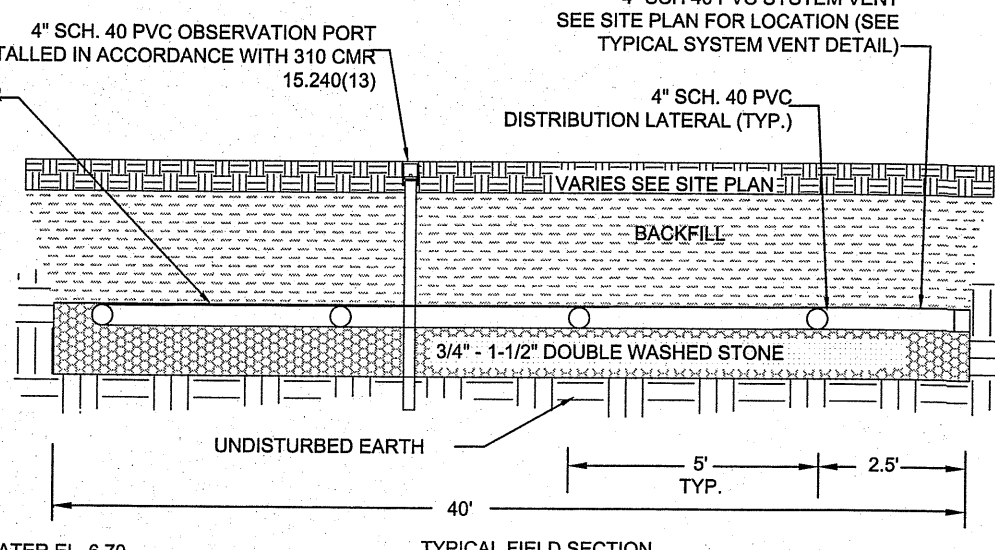

PIPE TRENCH DETAIL
NOT TO SCALE

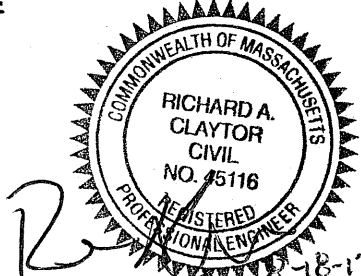

ZONING & RESOURCE PROTECTION NOTES

- PARCEL ID: 74-050
OWNER OF RECORD: TOWN OF SANDWICH
ADDRESS: 16 DEWEY AVENUE
- THE LOCUS IS IN LOCATED IN FLOOD ZONE X (AREA OUTSIDE THE 0.2% ANNUAL CHANCE OF FLOODPLAIN (AS SHOWN ON F.I.R.M. MAP 25001C0534) DATED JULY 16, 2014).
 - THE SITE IS NOT LOCATED IN A WELLHEAD PROTECTION AREA.

WASTEWATER NOTES

- UNLESS OTHERWISE NOTED, ALL SYSTEM COMPONENTS AND CONSTRUCTION METHODS SHALL BE IN ACCORDANCE WITH THE STATE ENVIRONMENTAL CODE AND THE RULES AND REGULATIONS OF THE LOCAL BOARD OF HEALTH.
- THIS PLAN IS INTENDED TO ADEQUATELY PROVIDE THE INFORMATION NECESSARY TO LAYOUT AND CONSTRUCT THE PROPOSED SEWAGE DISPOSAL SYSTEM REPRESENTED ON IT AND SHOULD NOT BE USED FOR ANY OTHER PURPOSES.
- ANY CHANGES TO THIS PLAN MUST BE APPROVED BY THE ENGINEER AND/OR THE LOCAL BOARD OF HEALTH (BOH) STAFF.
- PRIOR TO CONSTRUCTION, THE CONTRACTOR TO COORDINATE WITH THE ENGINEER ON FILING THE DISPOSAL SYSTEM PERMIT WITH THE TOWN. THE CONTRACTOR SHALL COORDINATE WITH THE PROPERTY OWNER AND ENGINEER ON THE CONSTRUCTION SITE ACCESS AND MATERIAL STOCK PILE AREAS.
- TRENCH SAFETY SHALL BE THE RESPONSIBILITY OF THE CONTRACTOR INCLUDING ANY LOCAL AND/OR STATE PERMITS REQUIRED FOR THE TRENCH WORK. THIS WORK MAY BE REQUIRED TO TAKE PLACE OUTSIDE OF NORMAL HOURS OF OPERATION FOR THE FACILITY. THE CONTRACTOR SHALL PLAN ACCORDINGLY.
- THE CONTRACTOR SHALL REPORT ANY DISCREPANCIES FOUND IN SITE CONDITIONS FROM THOSE SHOWN ON THE PLAN TO THE DESIGN ENGINEER.
- FAILING TO PROPERLY INSPECT OR PUMP THE SEPTIC TANKS AND TREATMENT SYSTEM OR CHANGES TO EFFLUENT FLOW, GRADING, OR LANDSCAPING, EITHER ON-SITE OR ADJACENT TO THE SITE, MAY RESULT IN IMPROPER FUNCTIONING OF THE SEPTIC AND LEACHING SYSTEM(S).
- CALL "DIGSAFE" AT LEAST 72 HOURS PRIOR TO COMMENCING CONSTRUCTION AT 1-888-DIG-SAFE AND ANY OTHER APPLICABLE AGENCIES TO FIELD VERIFY LOCATIONS OF EXISTING UTILITIES.
- THIS ON-SITE WASTEWATER TREATMENT SYSTEM IS NOT DESIGNED FOR USE WITH A GARBAGE GRINDER.
- THE OWNER SHALL INSPECT AND PUMP THE SEPTIC TANK ONCE EVERY 2 YEARS.
- PROVIDE WATERTIGHT SEALS BY USE OF NON-SHRINK GROUT AT ALL POINTS WHERE PIPES ENTER OR LEAVE ANY CONCRETE STRUCTURES.
- USE SCH. 40 PVC PIPING WITH WATERTIGHT JOINTS UNLESS OTHERWISE NOTED ON PLAN. ALL PIPE SHALL BE PLACED ON A COMPACTED FIRM BASE.
- ALL STONE TO BE DOUBLE-WASHED AND FREE OF DIRT, DUST, AND FINES.
- THE CONTRACTOR IS RESPONSIBLE FOR PROVIDING OPERATIONS AND MAINTENANCE INFORMATION FOR THE SEPTIC SYSTEM TO THE ENGINEER, IF NECESSARY.
- THE CONTRACTOR SHALL PROVIDE A DEWATERING PROTOCOL PRIOR TO CONSTRUCTION IF GROUNDWATER IS ANTICIPATED DURING CONSTRUCTION.
- UNSUITABLE SOIL MUST BE REPLACED WITH TITLE 5 SAND AS SPECIFIED IN 310 CMR 15.255(3). ANY ADDITIONAL AREAS THAT ARE FOUND TO HAVE UNSUITABLE MATERIAL SHALL BE REPORTED TO THE ENGINEER.
- ALL SEPTIC COMPONENTS SHALL BE INSTALLED WITH MAGNETIC WARNING TAPE.
- ALL SEPTIC TANKS SHALL BE APPLIED WITH 2 COATS OF DAMP PROOFING OR BITUMINOUS MATERIAL.
- THE CONTRACTOR SHALL RESTORE ALL SURFACES EQUAL TO THEIR ORIGINAL CONDITION AFTER CONSTRUCTION IS COMPLETE. AREAS NOT DISTURBED BY CONSTRUCTION SHALL BE LEFT NATURAL. THE CONTRACTOR SHALL TAKE CARE TO PREVENT DAMAGE TO SHRUBS, TREES, OTHER LANDSCAPING AND/OR NATURAL FEATURES. WHEREAS THE PLANS DO NOT SHOW ALL LANDSCAPE FEATURES, EXISTING CONDITIONS MUST BE VERIFIED BY THE CONTRACTOR IN ADVANCE OF THE WORK.
- ALL UNPAVED AREAS DISTURBED BY THE WORK SHALL HAVE A MINIMUM OF 4-INCHES OF LOAM INSTALLED AND BE SEEDDED WITH GRASS SEED AS SHOWN ON THE PLAN AND/OR DIRECTED BY THE ENGINEER. THE CONTRACTOR SHALL BE RESPONSIBLE FOR WATERING ANY LOAM AND SEEDD AREAS UNTIL LAWN GROWTH IS ESTABLISHED AND APPROVED BY THE ENGINEER AND/OR OWNER.
- ALL EXISTING SEPTIC COMPONENTS SHALL BE ABANDONED IN PLACE IN ACCORDANCE WITH TITLE 5, 310 CMR 15.354(3) AS DESCRIBED BELOW:
 - 14 DAYS PRIOR TO DISCONTINUING USE OF THE EXISTING SYSTEM THE CONTRACTOR SHALL APPLY TO THE BOARD OF HEALTH FOR SYSTEM ABANDONMENT.
 - UPON APPROVAL FROM THE BOARD OF HEALTH, THE CONTRACTOR SHALL PUMP THE EXISTING LEACHING PIT OF ITS CONTENTS BY A LICENSED SEPTIC HAULER.
 - THE BOTTOM OF THE EXISTING PIT SHALL BE OPENED OR RUPTURED TO PREVENT RETAINAGE OF WATER.
 - THE EXISTING LEACHING PIT SHALL BE COMPLETELY FILLED WITH CLEAN SAND OR OTHER SUITABLE MATERIAL APPROVED BY THE BOARD OF HEALTH AND ENGINEER.

WASTEWATER INSTALLATION INSPECTION NOTES

- THE CONTRACTOR SHALL PROVIDE A MINIMUM OF 24 HOURS ADVANCE NOTICE TO THE ENGINEER AND LOCAL BOARD OF HEALTH FOR ANY INSPECTION.
- ALL WASTEWATER SYSTEMS, INCLUDING THE LEACHING SYSTEM, SHALL BE INSPECTED BY THE ENGINEER OR THE LOCAL BOH REPRESENTATIVE PRIOR TO BACKFILLING. AT A MINIMUM THE FOLLOWING ITEMS SHALL BE INSPECTED:
 - EXCAVATION OF LEACHING FIELD PRIOR TO PLACING SYSTEM STONE/COMPONENTS
 - LEACHING FIELD COMPLETE INSTALLATION PRIOR TO BACKFILL
 - ALL SYSTEM COMPONENTS BASE AND INSTALLATION PRIOR TO BACKFILL
 - LEAKAGE TEST ON SEPTIC TANK (MIN. 24 HR)
 - START UP TEST OF SYSTEM WITH ALL COMPONENTS INSTALLED AND FUNCTIONING AS DESIGNED
 - FINAL INSPECTION OF BACKFILLED SYSTEM
- THE CONTRACTOR SHALL BE RESPONSIBLE TO MAINTAIN UP-TO-DATE AS-BUILT DRAWINGS AND NOTES INDICATING THE HORIZONTAL AND VERTICAL LOCATION WITH TWO TIES OF ALL SYSTEM COMPONENTS INSTALLED. THESE AS-BUILT DRAWINGS AND NOTES WILL BE UTILIZED BY THE ENGINEER FOR THE PREPARATION OF RECORD PLANS.

SCHEDULE OF ELEVATIONS	
	EL.
BUILDING SERVICE	13.6
3,000 GALLON TANK- TOP	14.40
3,000 GALLON TANK- INLET	12.98
3,000 GALLON TANK- OUTLET	12.73
3,000 GALLON TANK- BOTTOM	8.56
10" BOX- TOP	13.89
10" BOX- INLET	12.72
10" BOX- OUTLET	12.55
10" BOX- BOTTOM	11.90
BED INVERT IN	12.47
BREAKOUT	12.80
LATERAL DISTAL INVERT	12.24
BOTTOM OF SYSTEM (BEGINNING)	11.97
BOTTOM OF SYSTEM (DISTAL)	11.74
ESHW (STANDING WATER IN TP-3)	6.70
SEPARATION TO ESHW	5.04

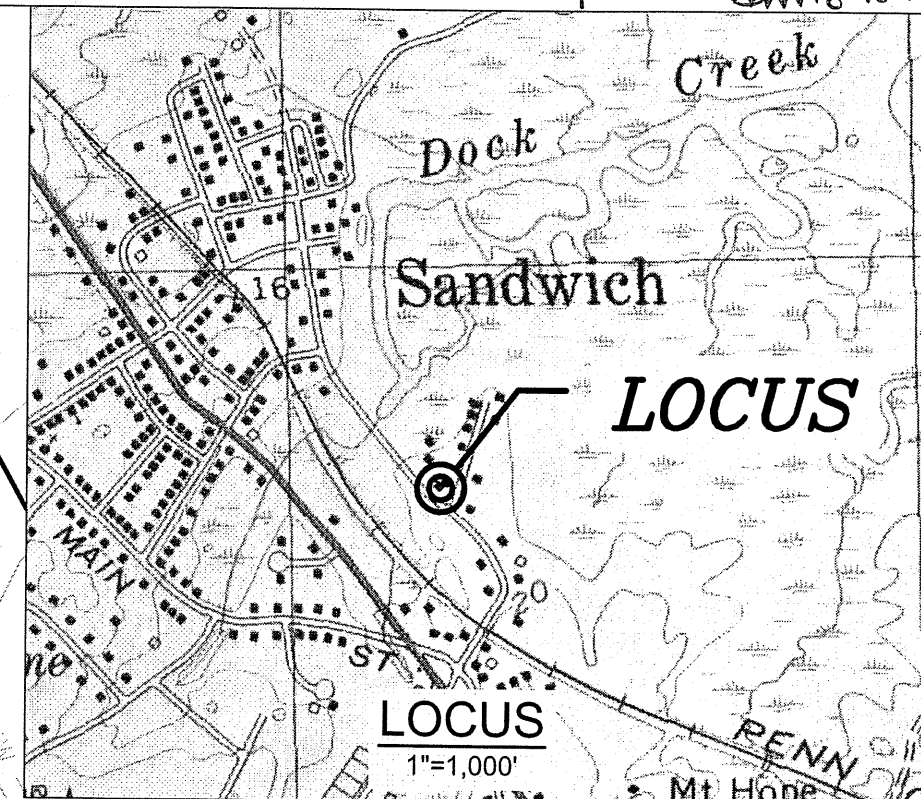
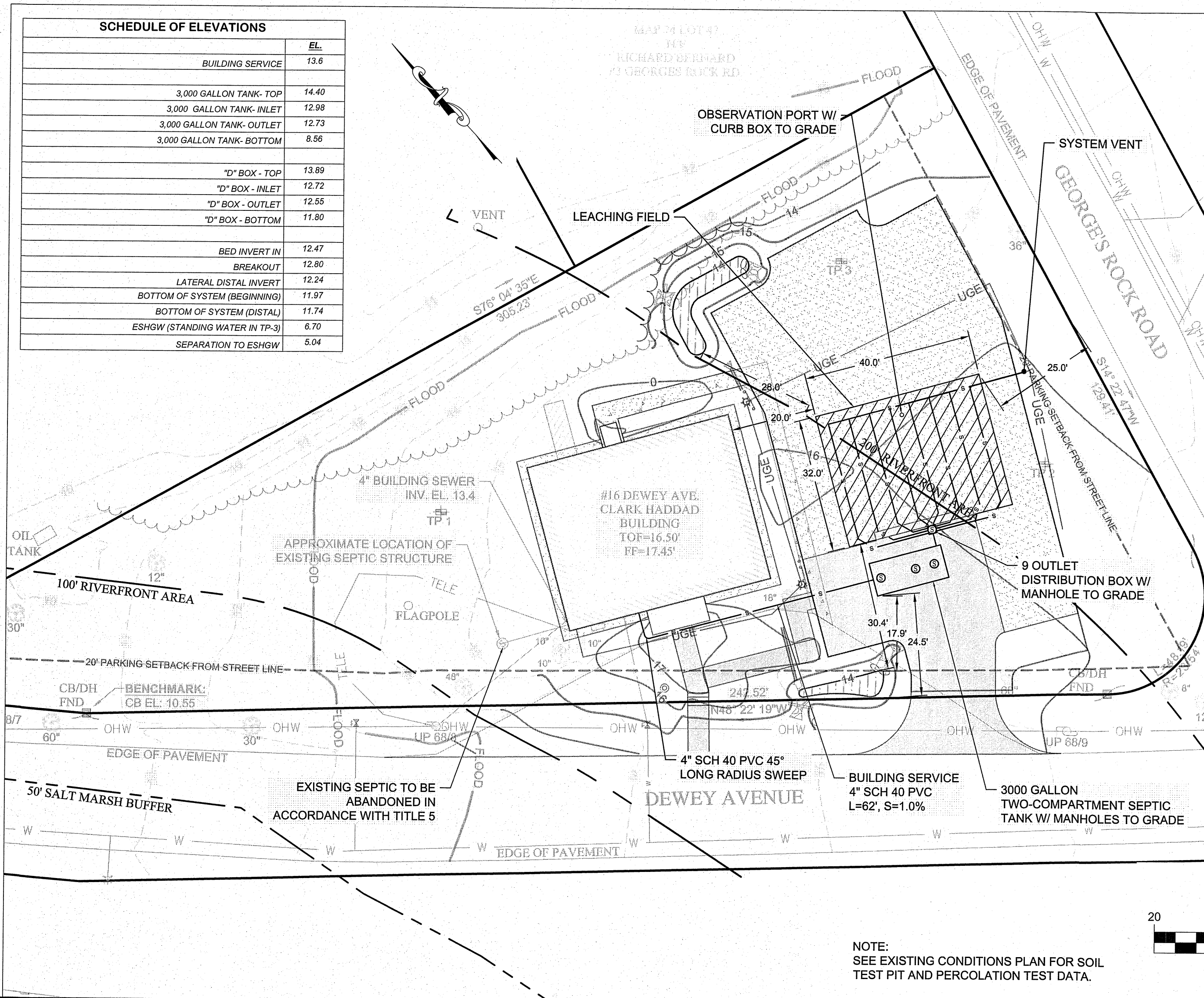

TREATMENT SYSTEM DESIGN CRITERIA		
DESIGN FLOW	945	GPD
SEPTIC TANKS		
COMPARTMENT 1 - 200% OF TOTAL DAILY FLOW:		
2 X 945 GPD:	1,890	GAL
COMPARTMENT 2 - 100% OF TOTAL DAILY FLOW:		
1 X 945 GPD:	945	GAL
TOTAL TANK CAPACITY:	2,835	GAL
USE NEW 3,000 GALLON SEPTIC TANK		
LEACHING SYSTEM DESIGN CRITERIA		
SOIL ABSORPTION SYSTEM		
LEACHING SYSTEM USED:	BED	
DESIGN PERCOLATION RATE:	2	MIN./IN.
SOIL CLASS:	I	
LONG TERM ACCEPTANCE RATE (LTAR):	0.74	GPD/S.F.
TOTAL AREA REQUIRED:	1,278	S.F.
TOTAL AREA PROPOSED:		
AREA: 32L x 40W:	1280	S.F.
DESIGN FLOW PROVIDED:	947	GPD
USE 1 - 32L x 40W LEACHING FIELD		

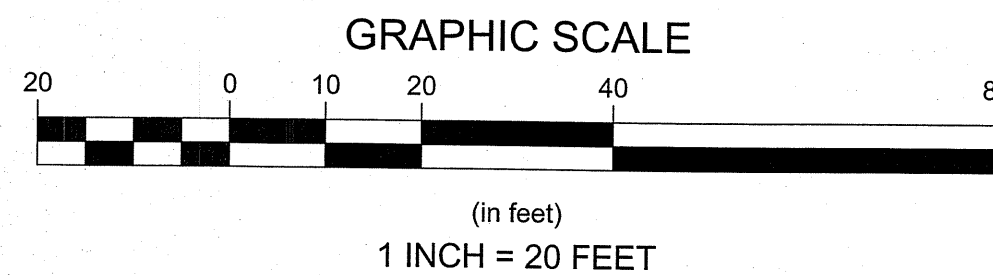

NOTE:
SEE EXISTING CONDITIONS PLAN FOR SOIL
TEST PIT AND PERCOLATION TEST DATA.



The Clark-Haddad Memorial Building

16 Dewey Ave, Sandwich, MA, 02563

Town of Sandwich

Horsley Witten Group, Inc.
Sustainable Environmental Solutions
www.horsleywitten.com
90 Route 6A
Sandwich, MA 02563
508-833-6600 voice
508-833-3150 fax

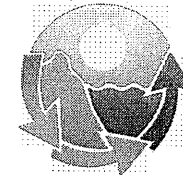

Date: 08/22/17
Reviewed By: RAC
Drawn By: AP/JL
Designed By: AP/JL
Project No: 17005
Revision Date: ----

MK & A McGinley Kalsow & Associates, Inc.
ARCHITECTS & PRESERVATION PLANNERS
324 Broadway, P.O. Box 45248
Somerville, MA 02145
617.625.8901 - www.mcginleykalsow.com

Utility Plan

No.

C-5